

DS-46SW370 DC WORM GEAR MOTOR

Main Voltage : 6VDC、12VDC、24VDC

Typical Applications :

Optical instrument, Surveillance cameras, Automated energy efficiency, Water saving equipment, IC water card, Toys and gifts, Office equipment, Household appliance, automation equipment



APPFARANCF SIZE

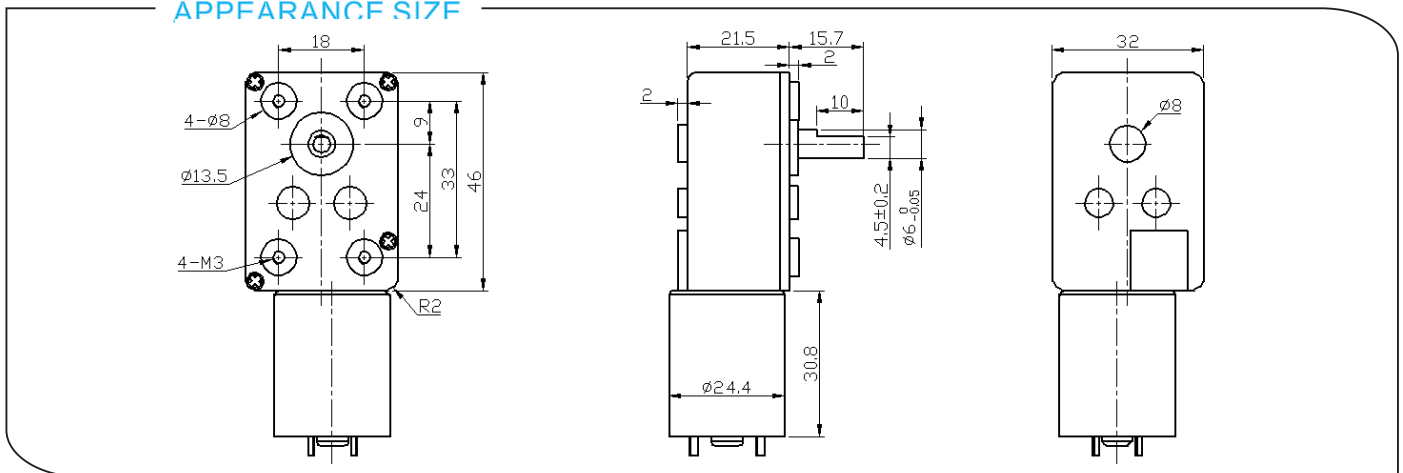

Gearbox Data:

Number of stages	3	4	5
Reduction ratio	69、100、180、255	330、950	1650、5300
Gearbox length "L"mm	25.5	25.5	25.5
Breaking torque(kgf.cm)	6	15	30
Gearbox efficiency	40%	36%	32%

Driving Motor Data:

Motor model	Rated Volt.	No load		Load				Stall	
		Current	Speed	Current	Speed	Torque	Output power	Torque	Current
		V	mA	r/min	mA	r/min	gf.cm	W	gf.cm
DS-370-006-3000	6	≤40	3000	≤160	2500	15	0.4	≥68	≥520
DS-370-006-4500	6	≤56	4500	≤300	3300	25	0.8	≥115	≥860
DS-370-006-6000	6	≤80	6000	≤450	4500	35	1.6	≥165	≥1800
DS-370-012-3000	12	≤20	3000	≤80	2500	15	0.4	≥68	≥250
DS-370-012-4500	12	≤35	4500	≤150	3300	25	0.8	≥115	≥550
DS-370-012-6000	12	≤50	6000	≤220	4500	35	1.6	≥165	≥980

Remark:

Gear Motor Torque=Driving motor torque*Reduction ratio*Gearbox efficiency;

Gear Motor Speed=Driving motor speed/Reduction ratio

Motor detailed config can be customized according to customer's requests, like voltage,speed,as well as shaft length and shape...

Welcome OEM or ODM projects